

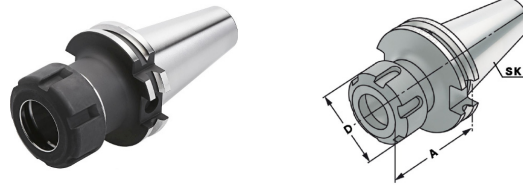

Kleštinový upínač pro kleštiny ER

Collet chucks for collets ER-system



DIN 6499 (ISO 15488)



Název Catalog number	Kužel Taper	Rozsah Capacity	D	A			G 2,5 25.000 min ⁻¹
SK40.63.ER.16.AD	SK40	1 – 10 (ER 16)	32	63	AD	ER16K	•
SK40.70.ER.20.AD	SK40	2 – 13 (ER 20)	35	70	AD	ER20K	•
SK40.60.ER.25.AD	SK40	2 – 16 (ER 25)	42	60	AD	ER25K	•
SK40.70.ER.32.AD	SK40	2 – 20 (ER 32)	50	70	AD	ER32K	•
SK40.80.ER.40.AD	SK40	3 – 26 (ER 40)	63	80	AD	ER40K	•
SK40.100.ER.16.AD	SK40	1 – 10 (ER 16)	32	100	AD	ER16K	•
SK40.100.ER.20.AD	SK40	2 – 13 (ER 20)	35	100	AD	ER20K	•
SK40.100.ER.25.AD	SK40	2 – 16 (ER 25)	42	100	AD	ER25K	•
SK40.100.ER.32.AD	SK40	2 – 20 (ER 32)	50	100	AD	ER32K	•
SK40.100.ER.40.AD	SK40	3 – 26 (ER 40)	63	100	AD	ER40K	•
SK40.63.ER.16.ADB	SK40	1 – 10 (ER 16)	32	63	AD/B	ER16K	•
SK40.70.ER.20.ADB	SK40	2 – 13 (ER 20)	35	70	AD/B	ER20K	•
SK40.60.ER.25.ADB	SK40	2 – 16 (ER 25)	42	60	AD/B	ER25K	•
SK40.70.ER.32.ADB	SK40	2 – 20 (ER 32)	50	70	AD/B	ER32K	•
SK40.80.ER.40.ADB	SK40	3 – 26 (ER 40)	63	80	AD/B	ER40K	•
SK40.100.ER.16.ADB	SK40	1 – 10 (ER 16)	32	100	AD/B	ER16K	•
SK40.100.ER.20.ADB	SK40	2 – 13 (ER 20)	35	100	AD/B	ER20K	•
SK40.100.ER.25.ADB	SK40	2 – 16 (ER 25)	42	100	AD/B	ER25K	•
SK40.100.ER.32.ADB	SK40	2 – 20 (ER 32)	50	100	AD/B	ER32K	•
SK40.100.ER.40.ADB	SK40	3 – 26 (ER 40)	63	100	AD/B	ER40K	•
SK.40.130.ER.16.ADB	SK40	1 – 10 (ER 16)	32	130	AD/B	ER16K	•
SK.40.130.ER.20.ADB	SK40	2 – 13 (ER 20)	35	130	AD/B	ER20K	•
SK.40.130.ER.25.ADB	SK40	2 – 16 (ER 25)	42	130	AD/B	ER25K	•
SK.40.130.ER.32.ADB	SK40	2 – 20 (ER 32)	50	130	AD/B	ER32K	•
SK.40.130.ER.40.ADB	SK40	3 – 26 (ER 40)	63	130	AD/B	ER40K	•
SK40.160.ER.16.ADB	SK40	1 – 10 (ER 16)	32	160	AD/B	ER16K	•
SK40.160.ER.20.ADB	SK40	2 – 13 (ER 20)	35	160	AD/B	ER20K	•
SK40.160.ER.25.ADB	SK40	2 – 16 (ER 25)	42	160	AD/B	ER25K	•
SK40.160.ER.32.ADB	SK40	2 – 20 (ER 32)	50	160	AD/B	ER32K	•
SK40.160.ER.40.ADB	SK40	3 – 26 (ER 40)	63	160	AD/B	ER40K	•
SK40.200.ER.16.ADB	SK40	1 – 10 (ER 16)	32	200	AD/B	ER16K	•
SK40.200.ER.20.ADB	SK40	2 – 13 (ER 20)	35	200	AD/B	ER20K	•
SK40.200.ER.25.ADB	SK40	2 – 16 (ER 25)	42	200	AD/B	ER25K	•
SK40.200.ER.32.ADB	SK40	2 – 20 (ER 32)	50	200	AD/B	ER32K	•
SK40.200.ER.40.ADB	SK40	3 – 26 (ER 40)	63	200	AD/B	ER40K	•

dotávka: s vyváženou upínací maticí, bez montážního klíče

delivery: with balanced clamping nut, without wrench



Kleštinový upínač pro kleštiny ER

Collet chucks for collets ER-system

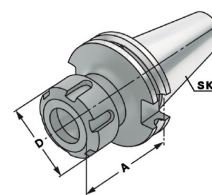

DIN 6499 (ISO 15488)



Název Catalog number	Kužel Taper	Rozsah Capacity	D	A			G 2,5 25.000 min ⁻¹
SK50.70.ER.16.ADB	SK50	1 – 10 (ER 16)	32	70	AD/B	ER16K	•
SK50.70.ER.20.ADB	SK50	2 – 13 (ER 20)	35	70	AD/B	ER20K	•
SK50.60.ER.25.ADB	SK50	2 – 16 (ER 25)	42	60	AD/B	ER25K	•
SK50.70.ER.32.ADB	SK50	2 – 20 (ER 32)	50	70	AD/B	ER32K	•
SK50.80.ER.40.ADB	SK50	3 – 26 (ER 40)	63	80	AD/B	ER40K	•
SK50.100.ER.16.ADB	SK50	1 – 10 (ER 16)	32	100	AD/B	ER16K	•
SK50.100.ER.20.ADB	SK50	2 – 13 (ER 20)	35	100	AD/B	ER20K	•
SK50.100.ER.25.ADB	SK50	2 – 16 (ER 25)	42	100	AD/B	ER25K	•
SK50.100.ER.32.ADB	SK50	2 – 20 (ER 32)	50	100	AD/B	ER32K	•
SK50.100.ER.40.ADB	SK50	3 – 26 (ER 40)	63	100	AD/B	ER40K	•
SK50.130.ER.16.ADB	SK50	1 – 10 (ER 16)	32	130	AD/B	ER16K	•
SK50.130.ER.20.ADB	SK50	2 – 13 (ER 20)	35	130	AD/B	ER20K	•
SK50.130.ER.25.ADB	SK50	2 – 16 (ER 25)	42	130	AD/B	ER25K	•
SK50.130.ER.32.ADB	SK50	2 – 20 (ER 32)	50	130	AD/B	ER32K	•
SK50.130.ER.40.ADB	SK50	3 – 26 (ER 40)	63	130	AD/B	ER40K	•
SK50.160.ER.16.ADB	SK50	1 – 10 (ER 16)	32	160	AD/B	ER16K	•
SK50.160.ER.20.ADB	SK50	2 – 13 (ER 20)	35	160	AD/B	ER20K	•
SK50.160.ER.25.ADB	SK50	2 – 16 (ER 25)	42	160	AD/B	ER25K	•
SK50.160.ER.32.ADB	SK50	2 – 20 (ER 32)	50	160	AD/B	ER32K	•
SK50.160.ER.40.ADB	SK50	3 – 26 (ER 40)	63	160	AD/B	ER40K	•
SK50.200.ER.16.ADB	SK50	1 – 10 (ER 16)	32	200	AD/B	ER16K	•
SK50.200.ER.20.ADB	SK50	2 – 13 (ER 20)	35	200	AD/B	ER20K	•
SK50.200.ER.25.ADB	SK50	2 – 16 (ER 25)	42	200	AD/B	ER25K	•
SK50.200.ER.32.ADB	SK50	2 – 20 (ER 32)	50	200	AD/B	ER32K	•
SK50.200.ER.40.ADB	SK50	3 – 26 (ER 40)	63	200	AD/B	ER40K	•

dodávka: s vyváženou upínací maticí, bez montážního klíče

delivery: with balanced clamping nut, without wrench