

# Internal turning tools

with coolant

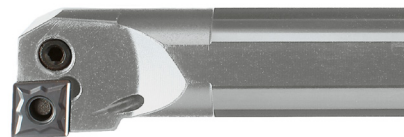
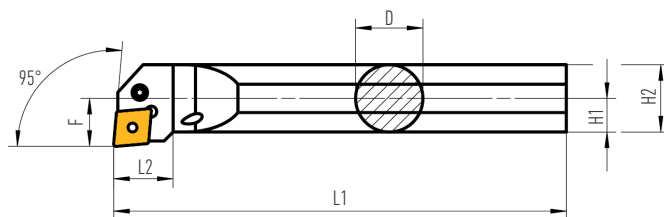

## Type A-PCLNR/L

	Order code	Dimensions (mm)						Insert	Pad	Spare parts				
		D	Dmin	H1	H2	L1	L2			F	Lever	Screw	Adapter	Assembly pin
steel shank	A25RPCLNR/L12	25	32	12,5	24	200	21	17				SP1114		
	A32SPCLNR/L12	32	40	16	31	250	24,1	22	CN..1204..	UP1111	HP1111	SP1111	RP1111	MP1111
	A40TPCLNR/L12	40	49	20	38,5	300	24,1	27						